



Total Laboratory Automation Solutions

---

**SATLARS™-TCA**

**thermo**  
scientific

---

Authorized Distributor

# Product Features

## HIGH THROUGHPUT

- Immunoassay module is compatible with super-high throughput CLIA analyzer--**MAGLUMI® X8** (up to 600 T/H/unit)
- Biochemistry module can connect to high-speed analyzer --**Biossays® C8** (up to 1600 T/H/unit)
- Centrifuge module throughput: up to 400 tubes/hour/unit
- Cold Storage Module: each storage unit with capacity of 14,800 tubes
- Decapper module throughput: up to 600 tubes/hour/unit
- Recapper module throughput: up to 500 tubes/hour/unit

## FLEXIBLE LAYOUT AND COMBINATION

- 4 models support customization according to your laboratories
- Each module is optional in accordance with your requirements
- Adapt to a variety of laboratory venues with high flexibility (can go through walls and bend)

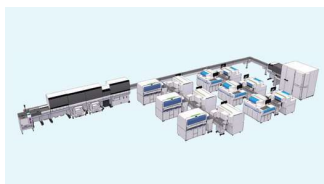

F Model



I Model

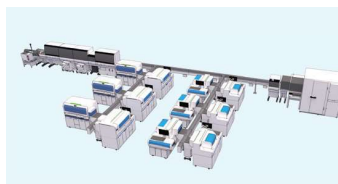

T Model

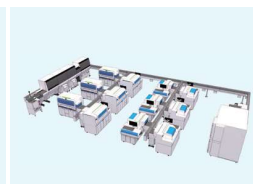

U Model

## FULLY AUTOMATION SOLUTION

- Sample assembly line including blood collection, analysis, and storage, saving time and manpower
- Automatic sample classification according to types of tests or colors of tube caps, easing operation burden
- Automatically check the measurement reports to reduce human error

### Automatic Blood Collection System



## HIGH SCALABILITY

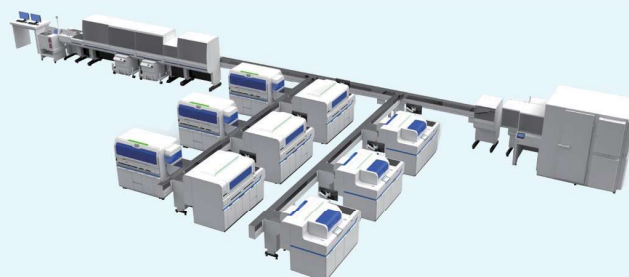

- Easy addition of new or exiting modules like centrifuge, decapper or other analytical modules for more functionality
- Compatible with fully-automatic analyzers by other mainstream manufactures including Abbott, Roche, etc



ES Flex Module



Centrifuge Module

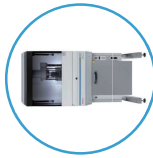

Decapper Module



Aliquoter & Labeler Module



Conveyors

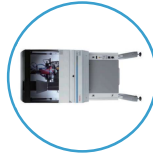

Recapper Module



Cold Storage Module



BES Flex module

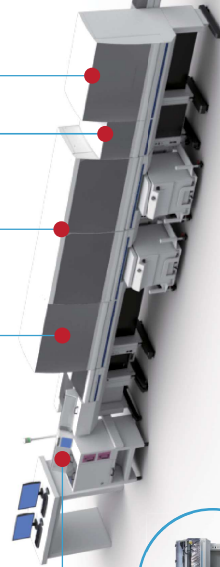

Automatic Biochemistry Analyzer  
--Biosays® C8



Fully-auto CLIA Analyzer  
--MAGLUMI® X6



Fully-auto CLIA Analyzer  
--MAGLUMI® X8

# Pre-Analytical Module

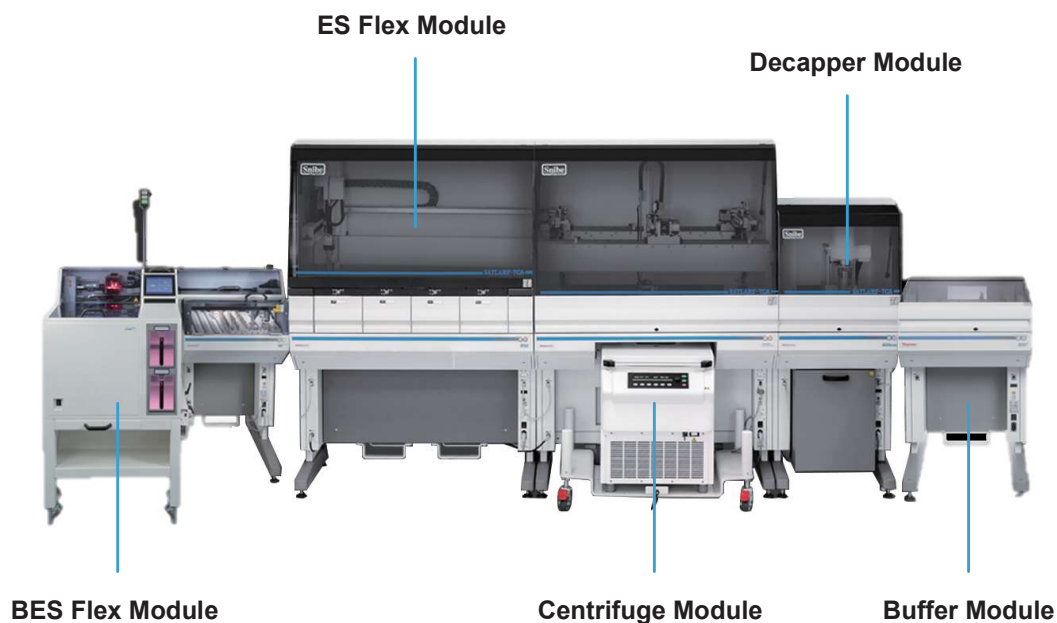

## ■ BES Flex Module

- Throughput: up to 750 tubes/hour
- Connect automatic blood collection system to realize remote sampling
- Capable of bulk loading or connecting to automatic sample loading system, to save manpower and simplify the process
- Sample classification according to the colors of caps, the sizes of tubes, etc.
- Can work independently from the system



## ■ ES Flex Module

- Up to 600 tubes/hour (combined input/output throughput)
- Tube capacity: up to 800 tubes/unit
- Various sample tubes and racks available
- Flexible assignment of sample entry and exit racks
- 4 user-defined sample drawers and racks
- Accurately position the location of recycled sample to facilitate searching for review



# Pre-Analytical Module

## ■ Centrifuge Module

- Throughput: up to 400 tubes/hour
- Capable to work independently from the system
- Fully-automated loading, balancing and unloading of the centrifuge racks
- Several user definable parameters: timing, acceleration, deceleration and temperature (-20 °C to +40 °C)
- Expandable centrifuge modules to shorten sample processing time
- Sufficient centrifugal force (up to 4300 g) to meet different test needs



## ■ Decapper Module

- Throughput: 600 tubes/hour
- Handling error tubes, such as broken or stuck caps
- Automatic alarm for cap disposal (capacity: 2500 caps)
- Automatic removal of screw and plastic caps
- Smart identification of the existence of cap and height & diameter of sample tubes
- Rotary opening cover, smooth and effective process to avoid aerosol splash



## ■ Buffer Module

- Storage area for empty carriers or for samples waiting for validation
- Tube capacity: 170 tubes/unit
- Effectively control the number of samples on the track at peak times to avoid track crowding
- Temporary parking of samples to wait for the result acceptance and re-routing



# Analysis Module

## ■ Immunoassay module is compatible with MAGLUMI® X Series

Excellent CLIA analyzers with advanced core technology--X-TECH



**MAGLUMI® X6**



**MAGLUMI® X8**

- Patented pipetting technology with disposable Tips ensures accurate and precise results and no cross-contamination
- Single cup design for each test with at least five-sided (X8 is 360°) incubation heating at  $37\pm0.3^{\circ}\text{C}$ , makes accurate, quick and uniform incubation
- Intelligent washing function with different mixing modes depending on different assays reduces the non-specific binding
- Super sensitive and stable measuring chamber with bidirectional temperature control technology ensures the accuracy of results

## ■ Biochemistry module is adapted to Biossays® C8

Unlimited choice for biochemistry

- The minimum volume of reaction liquid is 80  $\mu\text{L}$
- Precise and convenient pipetting technology assures dispense accuracy
- Intelligent stirring needle with hydrophobic plating to avoid cross-contamination to the greatest extent
- High quality optical system with stable light intensity and low fluctuation

1600T/H  
300T/H(ISE)



## ■ Open-ended Third Party Platform Module

- Open architecture to connect the third-party analyzers from different manufacturers including Abbott, Roche and other mainstreams





# Post Analytical Module

---

## ■ Recapper Module

- Throughput: 500 tubes/hour
- Special caps for different types of sample tube with different diameters
- Continuous caps loading with 2000 cap capacity
- Automatic capping to reduce biohazardous exposure



## ■ Cold Storage Module

- Storage capacity: up to 14,800 tubes/unit
- Loading throughput: up to 700 tubes/hour
- Refrigerated storage system with programmable storage profiles
- Sample automatically retrieved back to the track for re-testing or discharged according to the programmable timing
- Four different programmable storage profiles according to the test
- Automatic discharge function



# Sample Carrier

---

- Single sample carrier with RFID chip minimizes the number of code sweeps, reducing error rate caused by multiple sweeps
- Barcode connected to LIS to get the information of testing assays
- Monitoring sample's position in real-time
- Run the shortest route to save testing time

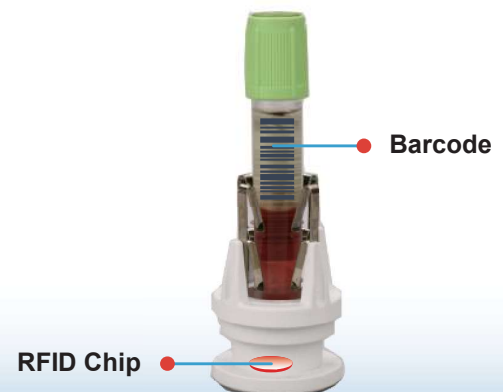

# COMPREHENSIVE TEST MENU

Compatible with **MAGLUMI®** X series analyzers (X6 and X8) and **Biossays®** C8, with one of the broadest test menu, including more than 200 immunoassay parameters and 74 biochemistry assays

## Immunoassay menu:

### Thyroid

TSH (3rd Generation)  
T4  
T3  
FT4  
FT3  
Tg (Thyroglobulin)  
TGA (Anti-Tg)  
Anti-TPO  
TRAb  
TMA  
Rev T3  
T-Uptake

### Hypertension

Direct Renin  
Aldosterone  
Angiotensin I  
Angiotensin II  
Cortisol  
ACTH

### Inflammation Monitoring

CRP  
PCT (Procalcitonin)  
IL-6 (Interleukin 6)  
SAA (Serum Amyloid A)  
\*TNF-α

### Bone Metabolism

Calcitonin  
Osteocalcin  
25-OH Vitamin D  
Intact PTH  
β-CTX  
total P1NP

### Coagulation Markers

D-Dimer  
TAT  
TM  
PIC  
tPAIC

### Anemia

Vitamin B12  
Ferritin  
Folate (FA)  
EPO  
RBC Folate

### Fertility

FSH  
LH  
HCG/β-HCG  
PRL (Prolactin)  
Estradiol  
Testosterone  
free Testosterone  
DHEA-S  
Progesterone  
free Estradiol  
17-OH Progesterone  
AMH  
SHBG  
Androstenedione  
PIGF  
sFlt-1

### TORCH

Toxo IgG  
Toxo IgM  
Rubella IgG  
Rubella IgM  
CMV IgG  
CMV IgM  
HSV-1/2 IgG  
HSV-1/2 IgM  
HSV-1 IgG  
HSV-2 IgG  
\*HSV-2 IgM  
\*HSV-1 IgM  
\*Toxo IgG Avidity  
\*CMV IgG Avidity

### Glyco Metabolism

C-Peptide  
Insulin  
GAD 65  
Anti-IA2  
ICA  
IAA (Anti Insulin)  
Proinsulin  
\*Glucagon  
\*ZnT8

### Metabolism

Pepsinogen I  
Pepsinogen II  
Gastrin-17  
GH (hGH)  
IGF-I  
IGFBP-3

### Infectious Disease

HBsAg  
Anti-HBs  
HBeAg  
Anti-HBe  
Anti-HBc  
Anti-HBc IgM  
Anti-HCV  
Syphilis  
Anti-HAV  
HAV IgM  
\*HEV IgG  
\*HEV IgM  
HIV Ab/Ag Combi  
Chagas  
HTLV I+II  
*H.pylori* IgG  
*H.pylori* IgA  
*H.pylori* IgM  
2019-nCoV IgG  
2019-nCoV IgM  
SARS-CoV-2 S-RBD IgG  
SARS-CoV-2 Neutralizing Antibody  
SARS-CoV-2 Ag  
Monkeypox Virus Ag  
Dengue Virus IgG  
Dengue Virus NS1  
\*Dengue Virus IgM  
\**Chlamydia Pneumoniae* IgG  
\**Chlamydia Pneumoniae* IgM  
\**Mycoplasma Pneumoniae* IgG  
\**Mycoplasma Pneumoniae* IgM

### EBV

EBV EA IgG  
EBV EA IgA  
EBV VCA IgG  
EBV VCA IgM  
EBV VCA IgA  
EBV NA IgG  
EBV NA IgA

### Hepatic Fibrosis

HA  
PIIIP N-P  
C IV  
Laminin  
Cholyglycine  
GP73

### Immunoglobulins

IgM  
IgA  
IgE  
IgG

### Tumor Markers

AFP  
CEA  
Total PSA  
f-PSA  
CA 125  
CA 15-3  
CA 19-9  
PAP  
CA 50  
CYFRA 21-1  
CA 242  
CA 72-4  
NSE  
S-100  
SCCA  
TPA-snibe  
ProGRP  
HE4  
HER-2  
PIVKA-II

### Cardiac

CK-MB  
Troponin I  
Myoglobin  
hs-cTnI  
hs-CRP  
H-FABP  
NT-proBNP  
BNP  
D-Dimer  
Lp-PLA2  
MPO  
HCY

### Prenatal Screening

AFP (Prenatal Screening)  
free β-HCG  
PAPP-A  
free Estradiol

### Drug Monitoring

Digoxin  
CSA (Cyclosporine A)  
FK 506 (Tacrolimus)

### Veterinary testing

\*cTSH  
\*cTT4  
\*vFT4

### Autoimmune

Anti-CCP  
Anti-dsDNA IgG  
ANA Screen  
ENA Screen  
Anti-Sm IgG  
Anti-Rib-P IgG  
Anti-Scl-70 IgG  
Anti-Centromeres IgG  
Anti-Jo-1 IgG  
Anti-M2-3E IgG  
Anti-Histones IgG  
Anti-nRNP/Sm IgG  
Anti-SS-B IgG  
Anti-SS-A IgG  
TGA (Anti-Tg)  
Anti-TPO  
TRAb  
TMA  
ICA  
IAA (Anti Insulin)  
GAD 65  
Anti-IA2  
Anti-TG IgA  
Anti-tTG IgG  
\*DGP IgA  
\*DGP IgG  
\*ZnT8  
Anti-MPO IgG  
\*Anti-PR3 IgG  
\*Anti-GBM IgG  
\*Anti-Cardiolipin IgG  
\*Anti-Cardiolipin IgM  
\*Anti-Cardiolipin IgA  
\*Anti-Cardiolipin screen  
\*β2-Glycoprotein I IgG  
\*β2-Glycoprotein I IgM  
\*β2-Glycoprotein I IgA  
\*β2-Glycoprotein I screen

### Kidney Function

β<sub>2</sub>-MG  
Albumin  
\*NGAL

## Biochemistry menu:

### Cardiac

CK  
CK-MB  
α-HBDH  
LDH  
\*D-Dimer  
\*LDH1  
\*ACE  
\*IMA  
\*MYO

### Diabetes

GLU  
LAC  
HbA1c  
\*GSP  
\*D3-HB  
\*GA

### Hepatic

TBA  
ALT (SGPT)  
AST (SGOT)  
ALP  
GGT  
TBIL  
DBIL  
TP  
ALB  
\*Ammonia  
\*PA  
\*CHE  
\*AFU  
\*5'-NT  
\*Haptoglobin  
\*ADA

### Lipids

TBA  
HDL-C  
LDL-C  
TC  
TG  
ApoE  
ApoA1  
ApoB  
Lp(a)  
Hcy  
\*NEFA

### Inorganic Ion

Ca  
P (phos)  
Mg

### Renal

Cr (CREA)  
Uric Acid  
Urea  
Cys-C  
α1-MG  
β2-MG  
mALB  
\*Urine/CSF Protein  
\*RBP  
\*NAG

### ISE

Na<sup>+</sup>  
K<sup>+</sup>  
Cl<sup>-</sup>  
iCa<sup>2+</sup>  
pH

### Immune

IgM  
IgA  
IgG  
\*C3  
\*C4

### Anemia

Transferrin  
Fe (Iron)  
\*UIBC  
\*G6PD  
\*Ferritin

### Inflammation

CRP (Full Range)

### Rheumatism

ASO  
RF

### Pancreatic

α-AMY  
LIP

\* Available soon





## AVAILABLE THIRD-PARTY ANALYTIC CONNECTIONS

### ■ ABBOTT

ARCHITECT i2000SR  
ARCHITECT c8000/16000

### ■ BECKMAN COULTER

UniCel DxI 800  
AU-680 DTS

### ■ ROCHE

Cobas 8000  
Cobas pro  
Cobas 8100 Automation (Cobas p 512 / p 612)

### ■ SIEMENS

ADVIA Centaur XP

### ■ ORTHO CLINICAL DIAGNOSTICS

VITROS 3600 /4600/5600  
VITROS XT3400 / XT7600  
VITROS 5,1 FS/5,1 FS AT

### ■ THERMO FISHER SCIENTIFIC

Phadia Immunocap 1000

### ■ SYSMEX

HST  
XN-9000

### ■ WERFEN IL

ACL Top 700/750

### ■ TOSOH

AIA 1800/2000LA  
AIA CL1200/CL2400  
Tosoh G8/G11

### ■ DIASYS

Biomajesty JCA-BM6010/C

### ■ STAGO

STA-R Evolution  
STA R Max, Max<sup>2</sup>, Max<sup>3</sup>

### ■ DIASORIN

Liaison XL

\* Please consult with your local Snibe representative whether the above third-party analyzer interfaces are available in your region. The non-Snibe vendor would need to be in agreement to allow connecting with SATLAS™-TCA system. Consult third-party manufacturers and/or vendors for the above analyzer technical requirements.

MAGLUMI®, SATLARSTM and Biossays® are trademarks of Snibe.  
All other product names and trademarks are the property of their respective owners.



**Shenzhen New Industries Biomedical Engineering Co., Ltd.**  
**(SNIBE Co.,Ltd.)**

No.23, Jinxiu East Road, Pingshan District, 518122 Shenzhen,  
P.R. China

Tel: +86 755 26501514  
Email: sales@snibe.com

Fax: +86 755 26654850  
Web: www.snibe.com

DISTRIBUTOR:

Follow us on

